

Instructions for safe operation and use of windows

Correct Use

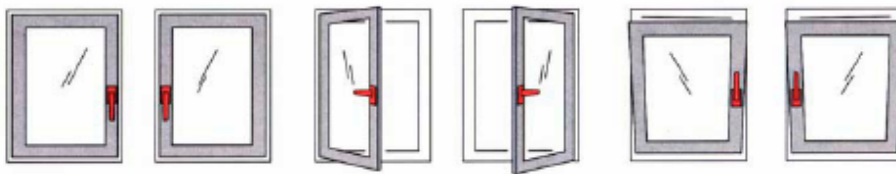

Incorrect Use!

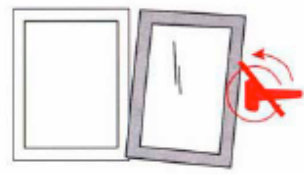

To maintain the long-term functionality and operating safety of the windows, follow the instructions below.

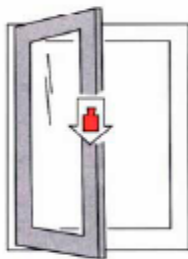

The window is not set up to bear additional weight. Any additional load may impair the performance of the window.

The handle is lockable for security and safety.

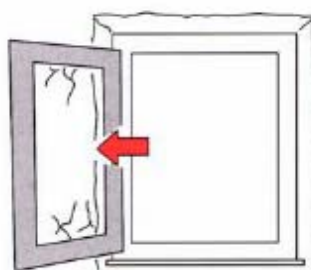

Use the handle, not the glass, to open and shut the window.

Do not leave the window open in strong winds.

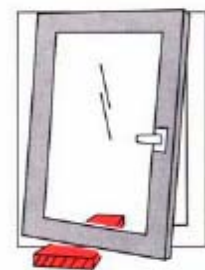

Do not place any items between the window and the frame

Attention! Rapid shutting of the window may cause injury.

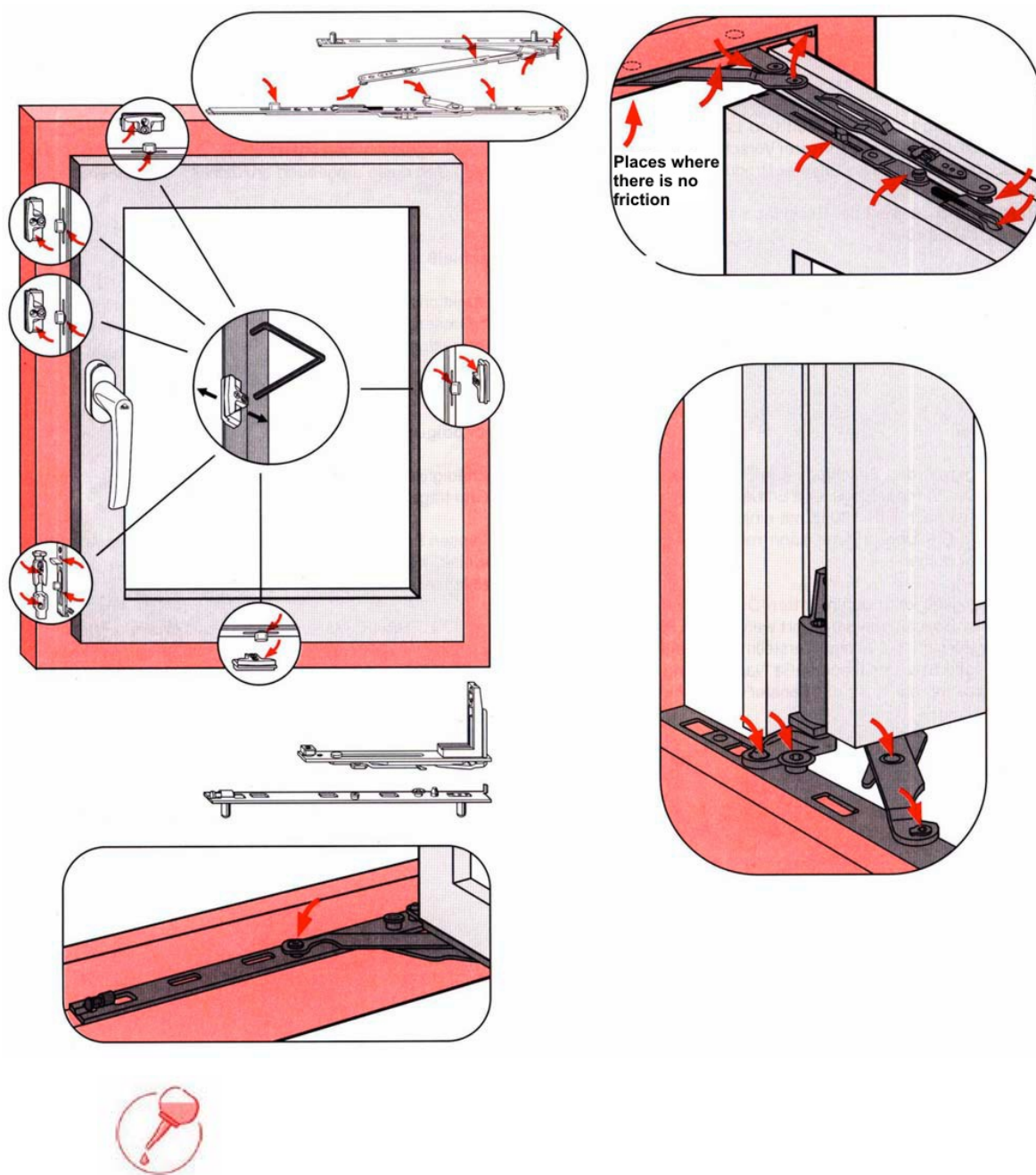

Maintenance

We strongly recommend that you treat all moving parts in the window and frame with oil on an annual basis. This will help maintain the smooth functioning of your ALBO fittings and maximise the product life. In addition, please check the position and condition of individual screws; any loose screws or screws with broken/damaged heads must be tightened or replaced immediately.

* Use a recommended lubrication oil from professional outlets.



Maintenance Recommendations

Using high-quality ALBO fittings ensures easy maintenance, problem-free functioning and a long service life. We advise that you be aware of the maximum sizes and weights regulations of a given ALBO window, and to follow the instructions contained in the guarantee terms for our products.

Easy operation of fittings

The ease of operation of the fittings can be assessed by measuring the value of the torque required on the window handle during the closing and opening of the window. According to the DIN 18055 standard, the value of the torque must not be higher than 10 Nm. Measurement is performed by means of a torque wrench.

Fitting operations can be improved by adjusting and oiling the fittings. Open-tilting fitting of ALBO products is done by adjusting two or three of the settings. Incorrect adjustment or adaptations made to our products by any party other than ALBO can negatively influence the functional properties of the window and will invalidate the product guarantee.

Fittings mounting

Correct functioning of the window and its safe operation depends on the safe mounting of the construction fitting. The strength and position of individual screws must be tested. If the screws are loose or the screw heads are broken/damaged, please tighten or replace the screw immediately.

Wearing of fittings

All relevant parts of the construction fitting must be treated with lubrication oil in accordance with our manuals in order to prevent wear and maximise the life of our products.

Damage of fittings

Damaged parts of the construction fittings must be replaced, especially load-bearing parts.

These are recommendations and should not be construed as allocating legal liability to ALBO.

ALBO recommends that producers of windows conclude a service contract with the final client.

Adjustment Options

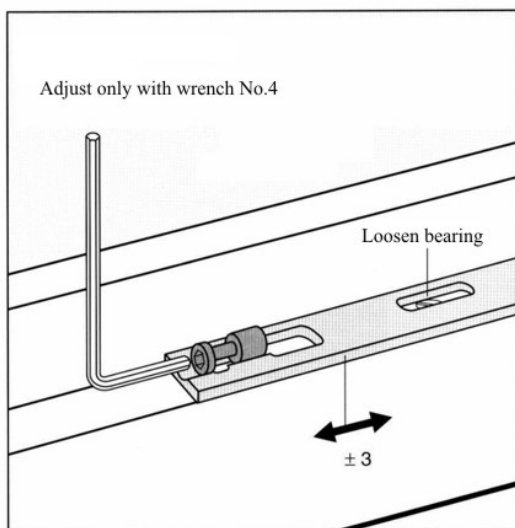

Frame bearing R

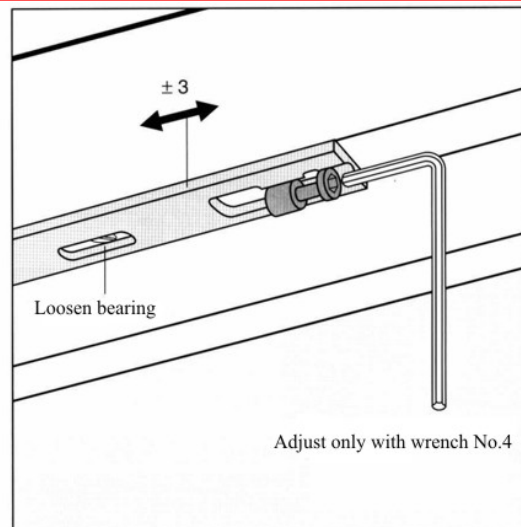

Frame scissors R

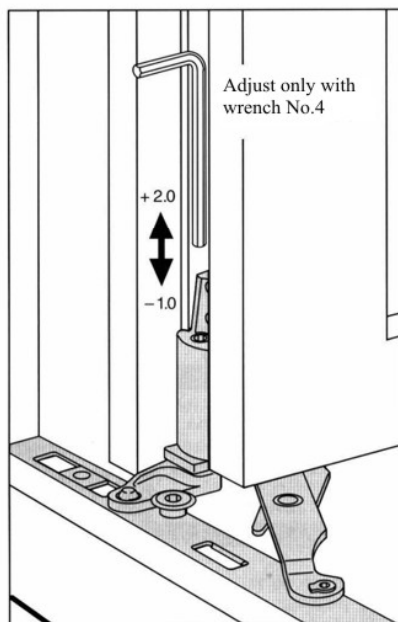

Wing hinge

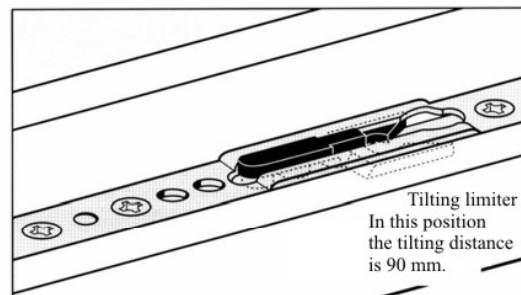

Tilting limiter for wing scissors R size 250

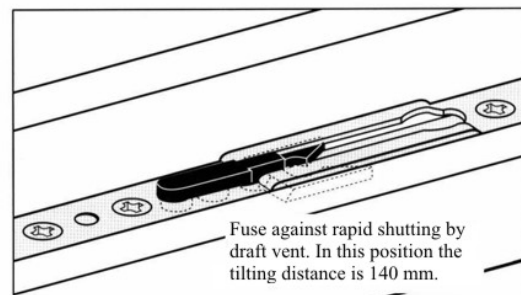

Arrester against rapid shutting is integrated into wing scissors R

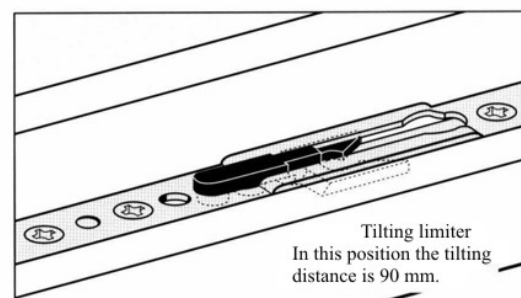

Tilting limiter for wing scissors R size 250

Hanging the wing

Removing the wing

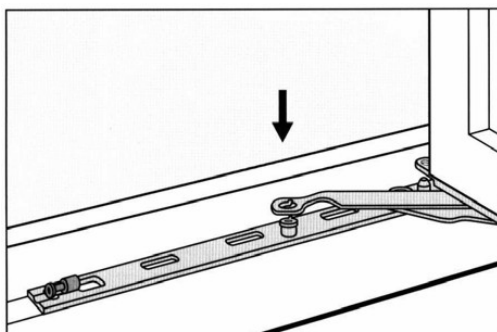

Frame bearing R

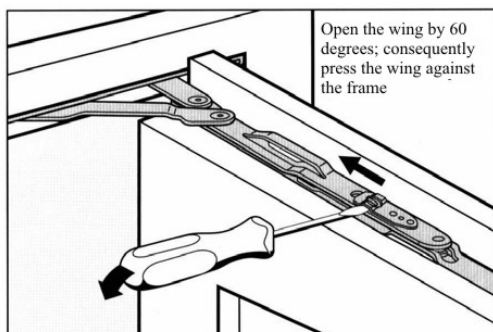

Frame scissors R

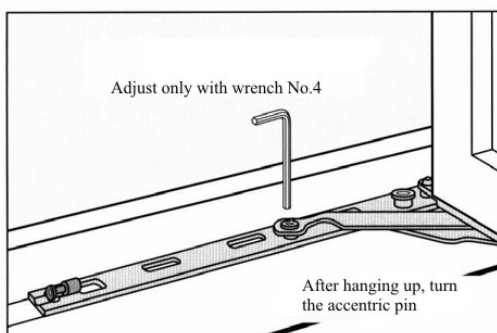

Frame bearing R

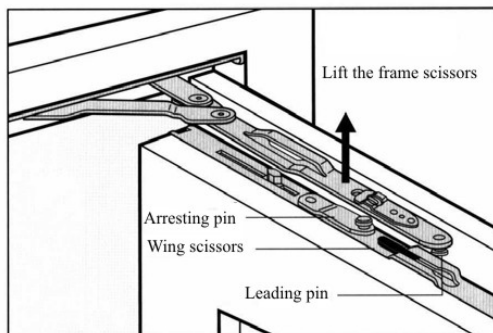

Frame scissors R

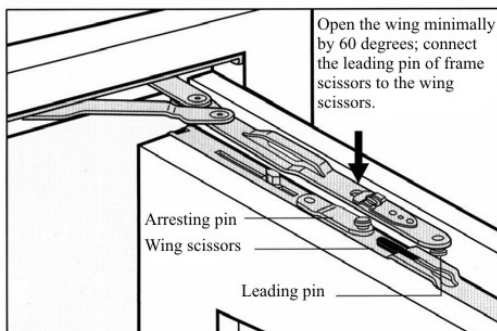

Frame scissors R

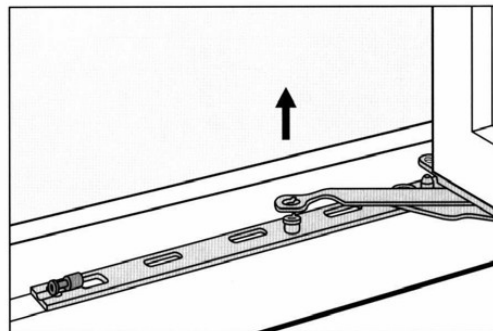

Frame bearing R

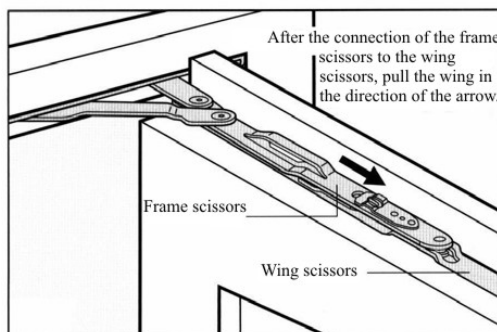

Frame scissors R

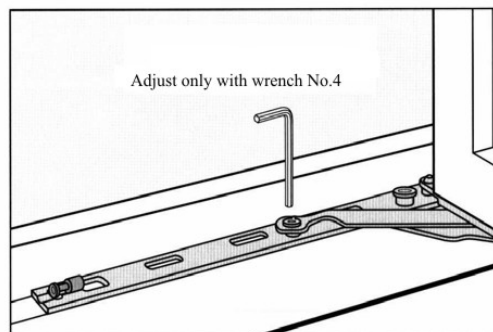

Frame bearing R